

#15003 Shaker Kitchen – Lower Cabinet 3" Kit

Step-by-step assembly instructions

Copyright miniatures.com 2024

SUPPLIES NEEDED:

Masking tape
White glue (such as #1249 Weldbond)
Damp clean cloth
Finishes



GENERAL INSTRUCTIONS

- Identify and inspect all parts using the Parts Diagram.
- Read the directions completely before beginning the project.
- If possible, have a dedicated work area so that you are not unpacking, repacking, and moving the project from place to place.
- Choose a work surface that is level, clean, dry, and protected from glue spills.
- Do a dry fit, using masking tape to hold parts in place, to make sure everything fits together correctly before assembling permanently.

Assembly Instructions

1. Glue the three **Shelves** into the grooves on a **Side**. They are flush on one edge while clearing the rabbet on the other edge.
2. Add the other **Side** to the assembly.
3. Glue the **Back** to the **Sides** and into their rabbet grooves.
4. Glue the **Footing** at the bottom front edge between the **Sides**.
5. Glue the **Toe Kick** over the **Footing**.
6. Glue the **Shorter Trim** to the front edges of the **Sides**. All edges are flush.
7. Glue the **Longer Trim** to the front edges of the top and bottom **Shelves**. The holes go on the same side as the door hinges.
8. Assemble and install the door.
9. Assemble and insert the drawer.
10. Glue on the **Top**. It is flush at the back and overhangs at the front.
11. Glue on the **Counter**. It is flush at the back and overhangs at the front.

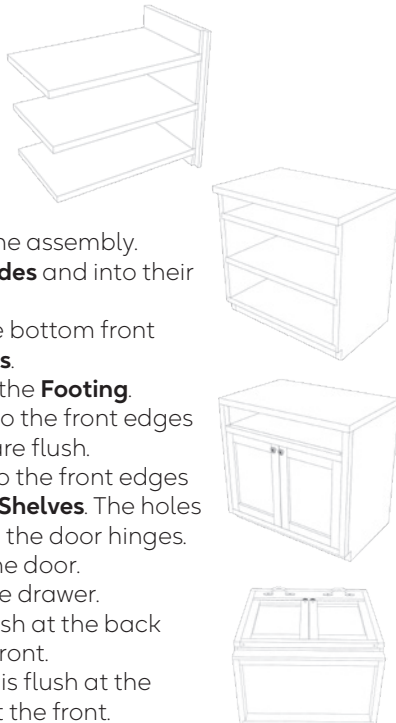

Tips:

- The kit is precisely cut to fit together with minimal sanding, if any. Where needed, use a fine grit paper on a sanding block.
- A fine-tipped glue applicator (such as the Pinpoint Glue Syringe Kit #10244) can be helpful.
- Stain the cabinets before assembly or paint after assembly.
- All drawers in the collection fit together the same way. The sides attach around the base. All outside edges are flush. Fronts have two predrilled holes for hardware; they are flush at the bottom edge and rises above the drawer.
- All doors in the collection fit together the same way. The door framing fits around the door panel and the back is flat. The frame piece that is contoured and has a hole at either end goes on the hinge side. The hole on the surface of a frame piece is for the pull. Pulls are at the top for lower cabinets and the bottom for upper cabinets.
- To install door hinges, insert one pin in the hole at the top or side of the frame. Push the pin through and into the corresponding hole in the door. Adjust the door alignment as necessary for the holes to align. Insert another pin through on the other end.

Assembly is now complete. Enjoy!

Parts Diagram

Note: Not to scale



Vertical Trim (x2)



Horizontal Trim (x2)

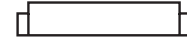

Door Frame Short (x4)



Toe Kick



Footing

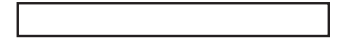

Door Frame Long



Drawer Handle (x2)



Drawer Front



Door Frame Long (knob)

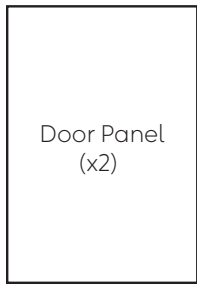

Door Panel (x2)

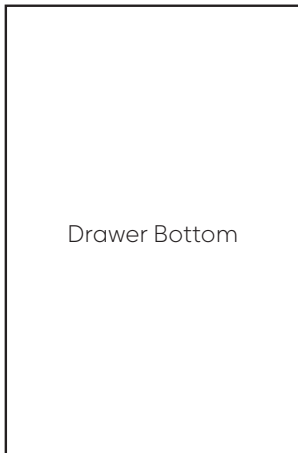

Drawer Bottom



Drawer Back



Drawer Sides (x2)



Counter

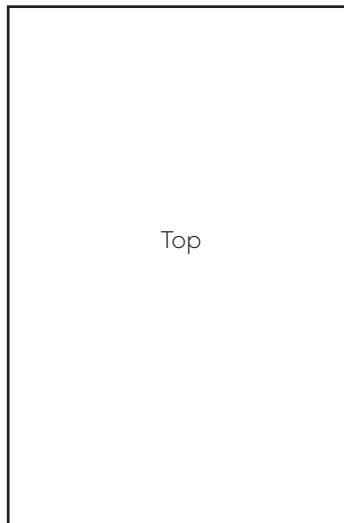

Top



Shelves (x3)



Pins (x4)

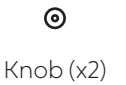

Knob (x2)

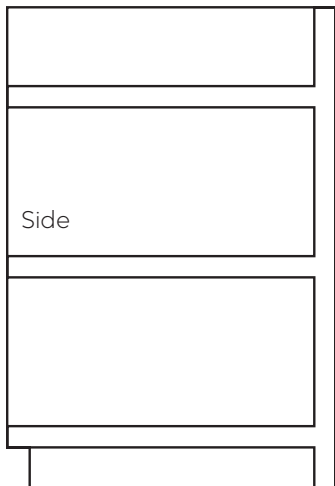

Side



Side

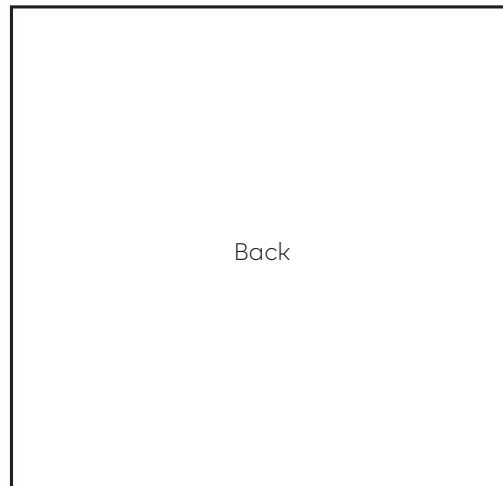

Back